

FORGE 1GigE IP67

Industrial Machine Vision Camera | FG-PGE-50S5M-C-IP / FG-PGE-50S5C-C-IP

KEY FEATURES

IP67 Protection

New Forge 1GigE camera series with IP67 cylindrical enclosure ensures easy integration, simplified cleaning, and protection from dust and water up to 1 meter.

Markets & Applications

Built for harsh environments, the Forge 1GigE IP67 cameras excel in smart agriculture and food applications, with auto-brightness (AGC and Auto-Exposure) for variable and outdoor lighting.

Additional Capabilities

With advanced machine vision features, the Forge 1GigE IP67 cameras include IEEE1588 for multi-camera sync and Lossless Compression (LLC) for higher frame rates and reduced bandwidth, optimizing output without sacrificing image quality.

APPLICATIONS

- Food and Beverage
- Automotive
- Precision Agriculture
- Pulp and Paper
- ITS / Traffic Enforcement

Versatile, Robust, and Cost Effective

The Forge® 1GigE IP67 series offers affordable, easy-to-use GigE Vision cameras designed for industrial imaging with IP67 ingress protection and robust data capture. Ideal for users seeking a 1GigE performance upgrade, Forge 1GigE offers a compact IP67 body, multiple resolutions (1.2 - 12MP), and lower deployment costs.

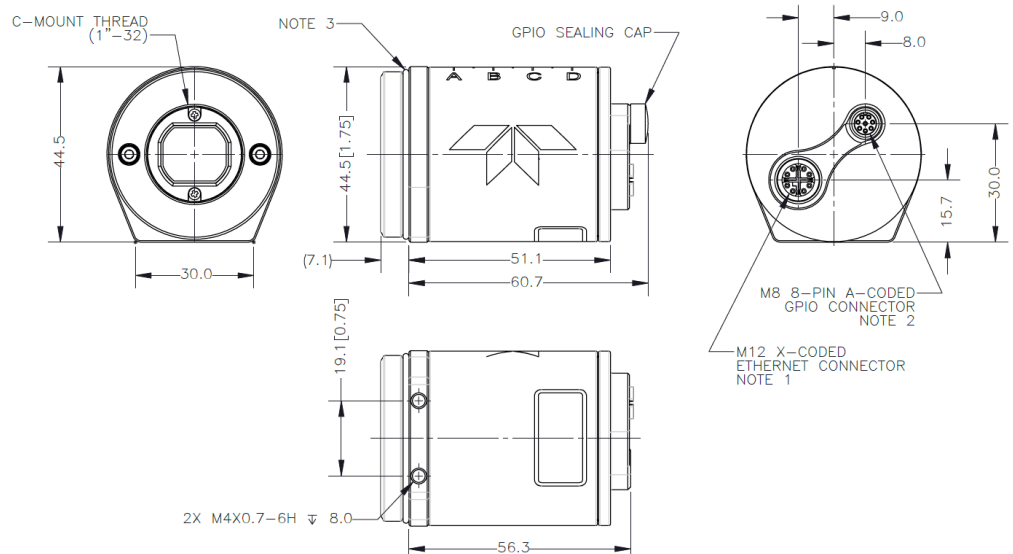

SPECIFICATIONS

| | FG-PGE-50S5M-C-IP | FG-PGE-50S5C-C-IP |
|----------------------------|---|---|
| Resolution | 2448 x 2048 | |
| Frame Rate | 24 fps | |
| Megapixels | 5.0 MP | |
| Sensor Model | Sony IMX264 | |
| Sensor Size | 2/3" | |
| Readout Method | Global shutter | |
| Pixel Size | 3.45 µm | |
| Spectrum | Mono | |
| Lens Mount | C-mount | |
| ADC | 12-bit | |
| Minimum Frame Rate* | 1 fps | |
| Gain Range | 0 – 47 dB | |
| Exposure Range* | 27 µs to 30 seconds | |
| Acquisition Modes | Continuous, Single Frame, Multi Frame | |
| Partial Image Modes | Pixel binning, decimation, ROI | |
| Image Processing | Gamma, lookup table, sharpness | Color correction matrix, gamma, lookup table, saturation, sharpness |
| Image Buffer | 240 MB | |
| User Sets | 2 | |
| Flash Memory | 6 MB (for user-defined data) | |
| Opto-isolated I/O | 1 input, 1 output (on an IP-rated I/O connector) | |
| Non-isolated I/O | 1 bi-directional, 1 input (on an IP-rated I/O connector) | |
| Serial Port | Supported (on an IP-rated I/O connector) | |
| Auxiliary Output | 3.3 V 120 mA | |
| Interface | 1 Gigabit Ethernet (on an IP-rated I/O connector) | |
| Power Requirements | Power over Ethernet (PoE) or externally powered over GPIO (12 - 24 V) | |
| Power Consumption | 3.3 W maximum PoE / 2.3 W maximum GPIO | |
| Dimensions / Mass | 55 mm x 45 mm x 45 mm (without optics) / 132 g | |
| Machine Vision Standard | GigE Vision v1.2 | |
| Compliance | CE, FCC, RoHS, REACH. The ECCN for this product is: EAR099 | |
| Temperature | Operating: 0°C to 50°C / Storage: -30°C to 60°C | |
| Humidity (no condensation) | Operating: 20% - 85% / Storage: 20% - 95% | |
| Warranty | 3 Years | |

*Values are the same in binning and no binning modes

FOR MORE INFORMATION CONTACT:

THE AMERICAS
 T: +1 866.765.0827 (toll free)
 T: +1 604.242.9937
 E: mv-sales@teledyne.com

EUROPE, MIDDLE EAST, & AFRICA
 T: +49 7141 488817-0
 F: +49 7141 488817-99
 E: mv-eusales@teledyne.com
CHINA BEIJING OFFICE:
 T: +86-10-84669678 ex. 8019

SHANGHAI OFFICE:
 T: +86-21-32501002 ex. 801
 E: mv-chinasales@teledyne.com
 E: mv-taiwansales@teledyne.com
JAPAN AND ASIA PACIFIC
 T: +81-3-5422-7866
 E: mv-japansales@teledyne.com

This document does not contain information whose export/transfer/disclosure is restricted by the Canadian Export Control regulation. Teledyne FLIR reserves the right to make changes at any time without notice.
 © 2024 Teledyne FLIR

Revision Date: 2025 03 13