

A

B

C

D

Optical Specifications	
Magnification (X)	0.300
Working Distance (mm)	110±2
Telecentricity(°)	<0.1
Distortion (%)	<0.1
Depth Of Field (mm)	3.44
MTF30 (lp/mm)	>220
Aperture	3.75
Object Space NA	0.04
O/I Distance (mm)	273±2
Length (mm)	145.5
Sensor Size (φ mm)	11.0(2/3")
Mount	C-Mount
Weight (kg)	0.380

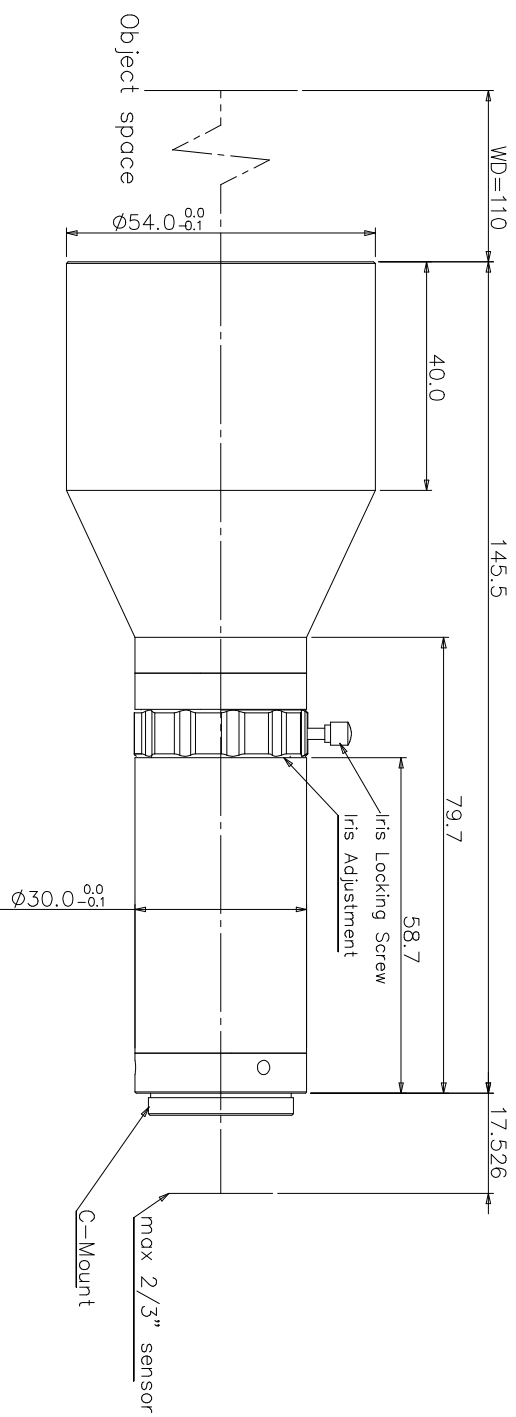

View Angle	Remark
Standard Difference	
TT14	

Item	Signature	Date
Drawing		
Design		
Check		
Approve		
Paper Size	A4	
Revised Date	2017-11-30	

OPT Machine Vision
广东奥普特科技股份有限公司

OPT-AS03-110A

Copyright © 2011 by OPT
 All Rights Reserved
 Drawing Code: KPPD20171130K08005

View Angle: Standard Difference
 Remark: TT14

Scale: 4:3
 Page: 1/1 Total Page
 Version: V1.0.1

A B C D