

**INFORMATION**

= No Update Services =  
04-Jul-2008 10:58

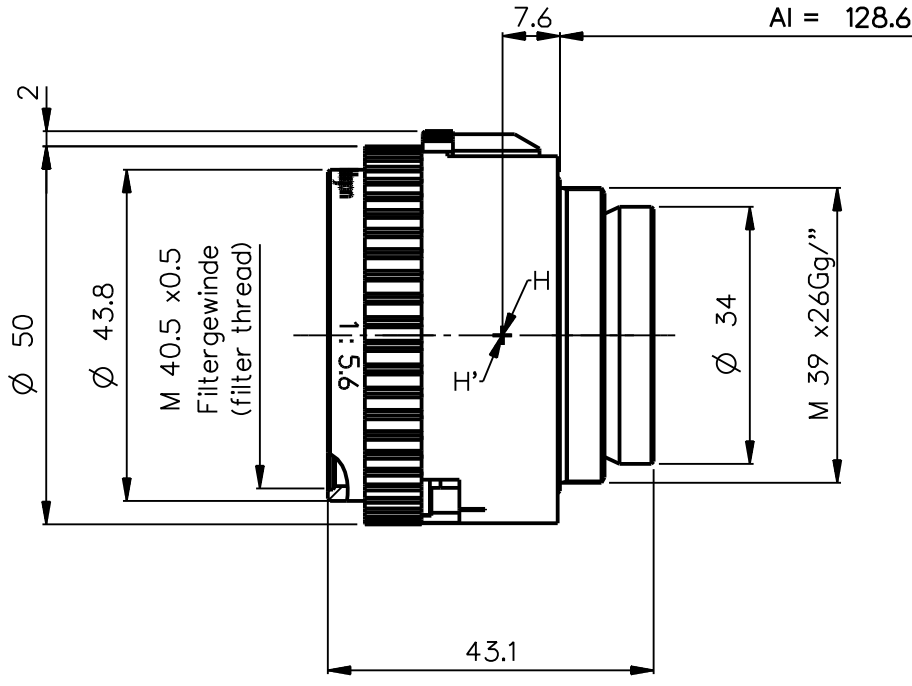

User: strozew  
Node: poug40  
Date: 04-Jul-08  
Time: 10:58

Weitergabe sowie Vervielfältigung dieser Unterlage, Verwertung und Mitteilung ihres Inhalts nicht gestattet, soweit nicht ausdrücklich zugestanden. Zuwiderhandlungen verpflichten zu Schadenersatz. Alle Rechte vorbehalten.

Copying of this document, and giving it to others, and the use or communication of the contents thereof, are forbidden without express authority. Offenders are liable to the payment of damages. All rights are reserved.

$f' = 136.2$	Brennweite focal length	9x12cm	Bildformat image format	Blende f-stop	Blenden-Ø aperture dia.
$S'_{f'} = 117.1$	Schnittweite back focal length	$2y' = 174.4$	Bildkreis-Ø image circle diameter		
$HH' = -0.08$	Hauptpunktstand nodal point distance	$\beta'_{opt} = 5x$	Optimierter Maßstab optimized scale	8	13.88
$AL_{\infty} = 128.6$	Auflagemaß unendlich flange focal distance	$2w = 56.0^\circ$	Bildwinkel image angle	11	9.81
ON 7461-9001				16	6.94
				22	4.91
Maße ohne Toleranzangabe sind Rechenmaße in mm dimensions without tolerances are nominal dimensions in mm					

<b>UG</b>						Status <b>in Arbeit</b>		
Schutzvermerk DIN 34 beachten	Rev.	Änd.-Beschr.	Datum	Name	zul. Abweichung für Mass, Form & Lage	Oberfläche	Maßstab <b>1:1</b>	
	a	Neuausg					-	Werkstoff
								Benennung
								<b>Rodagon 1:5.6 f=135mm</b>
								Zeichnungsnummer
<b>DIN A 4</b>						<b>LINOS</b>	<b>0701-398-100-00-0001a</b>	Blatt <b>1</b> von <b>1</b>
							Ersatz für	

# Rodagon\_135

MTF at ratio -0.2 f/ 5.6

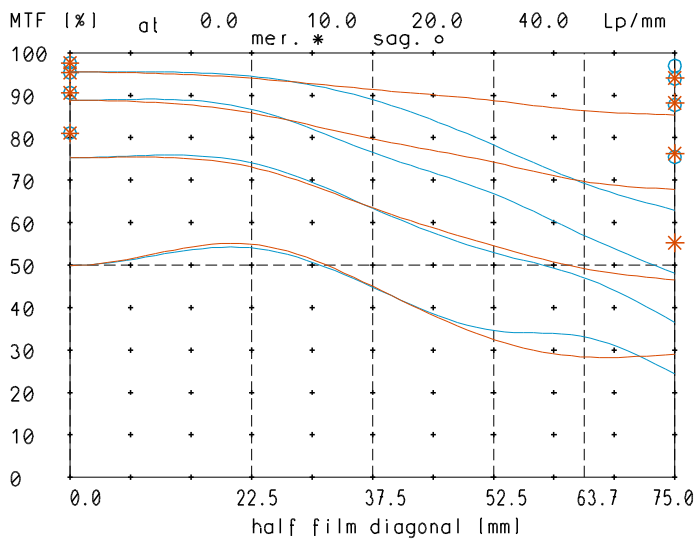

relative light fall-off at ratio -0.2

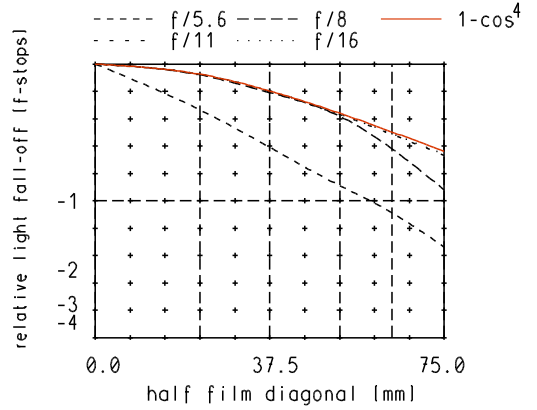

MTF at ratio -0.2 f/ 11

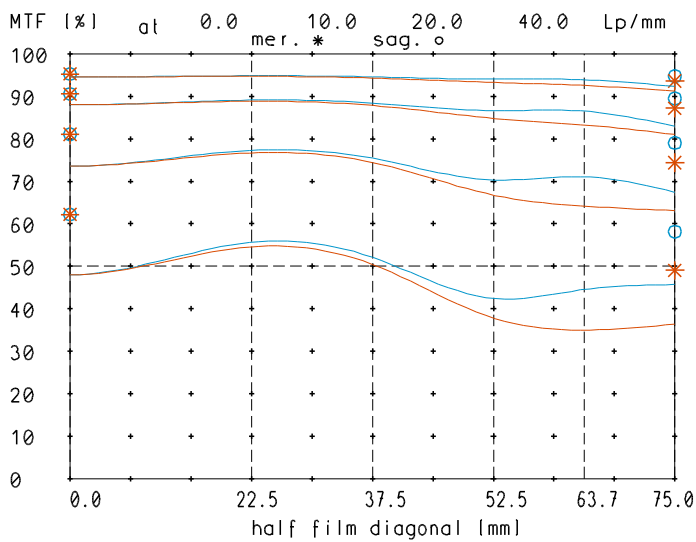

Distortion at ratio -0.05 to -0.3

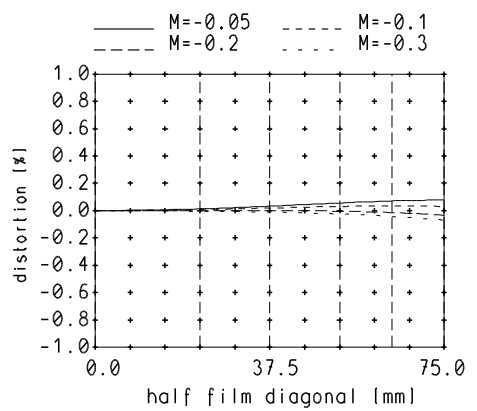

— sagittal, o Diffraction limited value  
— meridional\* Diffraction limited value

Longitudinal color aberration at ratio -0.2

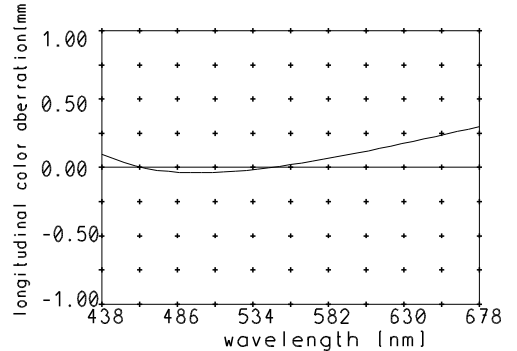

Named frequencies (line pairs/mm) in modular transfer function (MTF) as well as diagrams of relative light fall-off, distortion and longitudinal color aberration refer to film plane.